

ELIA CL



Scan the QR-code for the latest information

□ WH-RAL9016 / White RAL9016 /

LED device made from white polycarbonate designed for ceiling or surface mounting, ideal for lighting stairways, bathrooms/rest rooms and service areas, it is quick and easy to install, and features clean, minimalist lines

- Designed in two different sizes and power versions, it features a polycarbonate opal diffusing shell, a colour temperature of 4,000 K (neutral white) and a colour rendering index of more than 80
- It is also available in the Sensor version, with movement detection up to 8m, a radius of up to 120° and duration of 30 seconds, and in the Emergency version, the luminous flux is guaranteed for 3 hours of operation at 10%
- It has been designed to withstand temperature variations from -20°C to + 45°C, and offers protection from water and dust penetration of up to level IP54 and from shocks and impacts of up to level IK08
- Light and easy to handle, ELIA CL is easy to install thanks to the steel bracket on the back of the device for wall mounting, the quick-coupling terminal on the rear of the device for the electrical wiring and the bayonet locking mechanism for attaching the body of the light

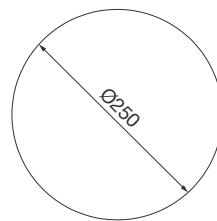

ELIA CL
S2 12W

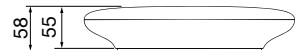
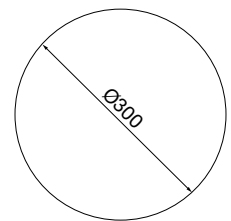

ELIA CL
M2 25W

ELIA CL S2 12W

IP20 - IK08 - 750 °C

LUMINAIRE WATTAGE [W]	CLASS	ENEC	DIN EN 12464-1	CRI	KELVIN	LIGHTSOURCE LUMEN OUTPUT [lm]	LUMINAIRE LUMEN OUTPUT [lm]	COLOUR / FINISH	PART NUMBER	UKCA
Power LED 220-240 V 50/60 Hz										
12	II	✓	-	80	4000	-	1300	<input type="checkbox"/>	GWF1310GA840	✓
12	II	✓	-	80	3000	-	1200	<input type="checkbox"/>	GWF1310GA830	✓
Power LED 220-240 V 50/60 Hz + HF Sensor										
12	II	✓	-	80	4000	-	1300	<input type="checkbox"/>	GWF1315GA840	✓
12	II	✓	-	80	3000	-	1200	<input type="checkbox"/>	GWF1315GA830	✓



ELIA CL M2 25W

IP20 - IK08 - 750 °C

LUMINAIRE WATTAGE [W]	CLASS	ENEC	DIN EN 12464-1	CRI	KELVIN	LIGHTSOURCE LUMEN OUTPUT [lm]	LUMINAIRE LUMEN OUTPUT [lm]	COLOUR / FINISH	PART NUMBER	UKCA
Power LED 220-240 V 50/60 Hz										
25	II	✓	-	80	4000	-	2600	<input type="checkbox"/>	GWF1310MA840	✓
25	II	✓	-	80	3000	-	2400	<input type="checkbox"/>	GWF1310MA830	✓
Power LED 220-240 V 50/60 Hz + HF Sensor										
25	II	✓	-	80	4000	-	2600	<input type="checkbox"/>	GWF1315MA840	✓
25	II	✓	-	80	3000	-	2400	<input type="checkbox"/>	GWF1315MA830	✓
Power LED - Emergency 3h - 220-240 V 50/60 Hz										
25	II	✓	-	80	4000	-	2600	<input type="checkbox"/>	GWF1314MA840	✓
Power LED - Emergency 3h - 220-240 V 50/60 Hz + HF Sensor										
25	II	✓	-	80	4000	-	2600	<input type="checkbox"/>	GWF1316MA840	✓

